

Rack and pinion door closer with link arm

Rack and pinion door closer with link arm

Product description

- Rack and pinion closer with link arm L190
- Certified in compliance with EN 1154, size 2-4
- Suitable for fire and smoke protection doors
- For single action doors up to 1100 mm wide

Overview of Advantages

- Can be used for left and right-handed doors
- Can be used with concealed mounting plate, suitable for fire and smoke protection doors
- Axis height adjustable up to 14 mm
- Closing speed, latching speed and backcheck adjustable via front facing regulating valves
- Thermodynamic valves for consistent performance
- Variable adjustable closing force
- Opening angle up to 180°
- Effective backcheck and latching speed range adjustable
- Large range of applications
- Standard colours: silver EV1; white, similar to RAL9016; brown, similar to RAL8014; black, similar to RAL9005
- Customised finishes available on request

Characteristics for hold open link arm L191

- Hold-open angle adjustable up to 150°
- Hold-open mode can be enabled and disabled as required
- Same installation as link arm
- Cannot be used with fire and smoke protection doors

Accessories/Individual parts

- Link arm L190Black, similar to RAL9005 DCL190-----9005
- Hold-open link arm L191Black, similar to RAL9005 DCL191-----9005
- Mounting plate A120For Door Closer Models DC200/DC300/DC500/DC700, galvanised DCA120-----40
- Angle bracket A122 DCA122-----9005
- Parallel arm bracket A154Black, similar to RAL9005 DCA154-----9005

The advantages at a glance

| Customer segment | Advantages |
|------------------|--|
| Project planners | Extensive range of uses: Fire and smoke protection doors as well as standard doors Modern design Compact design Fulfils barrier-free building requirements Same dimensions and design with and without mounting plate |
| Builders | One drilling template overall Adjustable to nearly all door and frame types Quick and easy installation Quickly and easily adjustable Suitable for left and right handed doors, in both door and frame mounted applications |
| Trade | Reduced inventory costs due to modular product range One single product suitable for a large variety of mounting positions Complementary accessories available for the whole product range |
| User | Largely unaffected by temperature fluctuations because of thermodynamic valves Easier door opening and improved accessibility due to rapidly decreasing torque Backcheck feature offers optimum protection for doors and walls |

Technical data

| | |
|---|--|
| Closing force | EN 2-4 |
| Door width up to | 1.100 mm |
| Suitable for fire doors | Yes |
| Handing | Left / right handed |
| Closing speed | Variable between 180°-15° |
| Latching speed | Variable between 15°-0° |
| Backcheck effect | Variable above 75° |
| Hold-open mode (with hold-open link arm L191) | Adjustable 75°-150°, can be enabled and disabled |
| Certified in compliance with | EN 1154 |

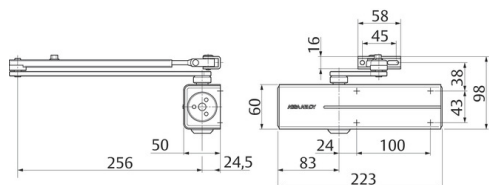

| | |
|----------------------------------|---------------------------|
| CE marking for building products | Yes |
| Length | 223 mm |
| Height | 60 mm |
| Depth | 50 mm |
| Weight | 1.6 kg |
| Color | Black, similar to RAL9005 |
| Article number | DC200-----D9005 |
| EAN-Number | 4042203687042 |