

Profile knob cylinder - system SK5

0534,KNF=1

Round knob with handle grip, anodised aluminium, 42 mm diameter

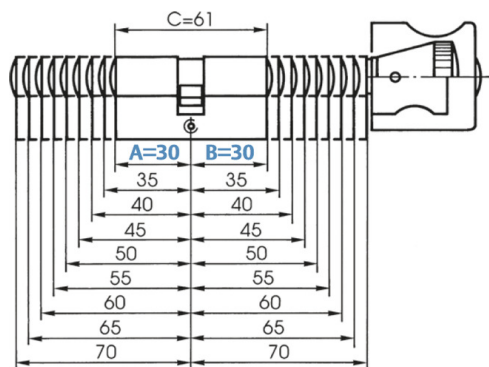
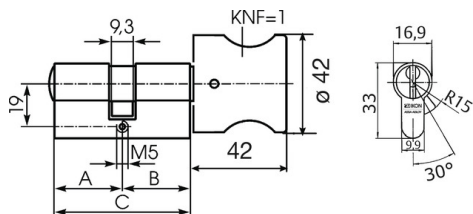

Product description

- 5 pin tumblers
- Brass cylinder
- Standard knob colour nickel silver (KNF=1F2)
- Other knob colours: silver (KNF=1F1)
- Standard finish, satin nickel-plated (OF=MV)
- Other surfaces: brass, mat brushed (OF=MG), polished brass (OF=MP)
- Basic cylinder length 61 mm (C) - A/B (L=30/30) - other installation lengths available
- Standard cam position (SST=30°)
- Other cam positions available
- Knob shaft extension in mm (KWV=20, 30, 40, 50, 60, 70, 80, 90, 100)
- Drilling protection (AB=), locking wave (SW=), additional lateral scanning, security card depending on profile (PR=)
- Spherical cylinder core head with reinforced key guide
- Cam made of break and corrosion-resistant nickel silver profile
- Core pins made of special wear-resistant bronze
- Key with round metal head
- Available for individual lockings and locking systems

Scope of delivery

- 1 profile-knob cylinder
- 3 nickel silver keys
- 1 cylinder fixing screw M5 x 85 mm

Ordering Information

- The knob is always on the inside of the cylinder (B)

Suitable ASSA ABLOY products

- Maintenance spray 8511
- Steel security fitting with cylinder cover - angled knob/handle S408
- Security escutcheon - round with cylinder cover S460
- Protector bar DRS 8443
- Protector bar DRS 8444
- Protector bar DRS 8446
- Protector bar DRS 8447
- Protector bar DRS 8448
- Protector bar DRS 8449
- Escutcheon with rain protection cover 1255
- Garage rod lock - standard package 9M31